

Limora Zentrallager

Industriepark Nord 21
D - 53567 Buchholz
Tel: +49 (0) 26 83 - 97 99 0
E-Mail: Limora@Limora.com
Internet: www.Limora.com

Filialen:

• Aachen • Berlin • Bielefeld
• Düsseldorf • Hamburg
• Köln • Stuttgart

Oil seal conversion kit for Austin Healey BN1 & BN2 (Part no. 327924)

Please Read fitting instructions Carefully Before Starting

Description: The oil seal housing is mounted at the rear of the block between the rear main bearing housing and the flywheel mounting flange on the crankshaft.

1. Remove crankshaft.
2. Machine the area of the scroll on the back of the crank down to the size of 2.500", leaving as larger radius in corner as possible.
3. Unbolt and remove the scroll housing off the rear face of the block.
4. Machine the scroll housing of the main bearing cap to be flush with the back plate face of the block.
NOTE: This need not necessarily be flush with the flat position of the cap.
5. If your main cap has only one oil drain hole, it is recommended that you also drill an extra hole in the cap as per the later engines. This is done as number 6.
6. After completing the last machine operation (no. 4), place the rounded half of the new seal housing onto the cap, then scribe around the cut out and mark the cap. A 3/8" dia hole at 33° should then be drilled on the centre of this scribed mark, making sure not to get too close to the bearing face (1/8" minimum). See Drawing.

Oil filter
paper-element
Part no.: 1008



Engine paint
Synthetic engine
enamel in original
colours, 1 litre.



Parts catalogue Austin Healey
BN1-BJ8,
600
pages,
Din A4
Part no.:
293127



Engine oil
HPR30 - 5 litre.
SAE20W/60 oil,
also replacement
for following
oils: SAE30 and
20W/50.
Part no.: 22856



Workshop Manual
Austin Healey BN1,
BN2, English, 300
pages.
Part no.: 202222

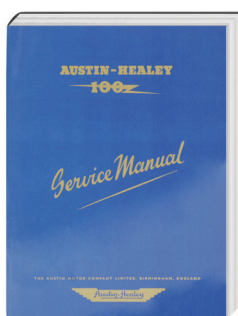

Oil drain pan
16l volume,
antisplash-
oilchange.
Part no.: 293584



**oil seal conversion kit
for Austin Healey BN1 & BN2
(Part no. 327924)**

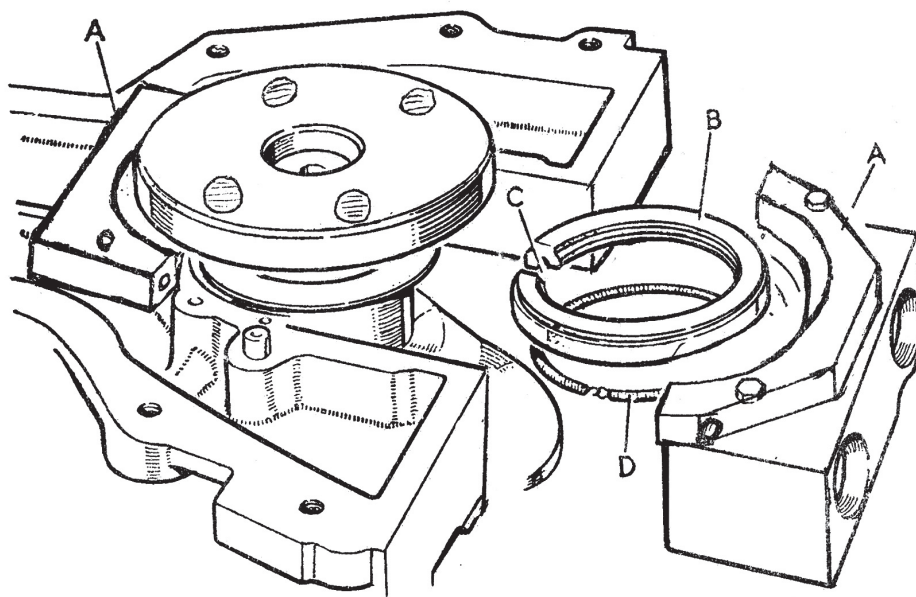

Fig 1. Retainer halves, oil seal and garter spring

A - Retainer halves

B - Split oil seal

C - Split line of seal towards top of engine

D - Garter spring, hook and eye midway between split and hinge of oil seal

Rounded
half of seal
housing

